

# Sky® 7Xi Mobile Device Disinfection

## Instructions for Use

### To Disinfect a Smart Phone or Tablet:

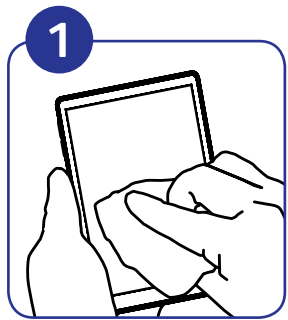

**1** Remove soil from device with a wet or dry wipe.

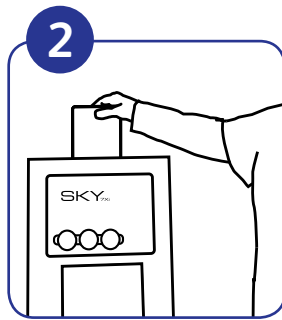

**2** Begin processing device through machine, centered in the opening, screen toward the back and insert firmly until rollers pull in the device.

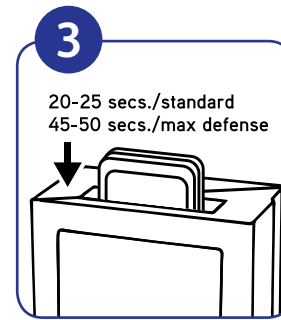

**3** Once the rollers engage, the unit will begin disinfecting the device - it will take 20-25 seconds for standard mode, and 45-50 seconds for max defense mode.

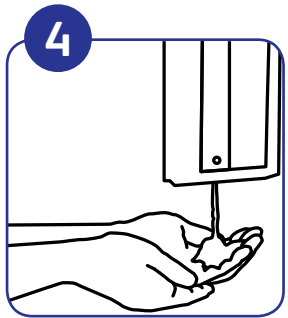

**4** Sanitize hands while device is processing.



**5** Lift lid to receive clean mobile device with freshly sanitized hands.

### To Avoid Damage to Smart Phone or Tablet, DO NOT:



Do not force device through the SKY.



Do not try to process any devices that are more than 1 inch thick.

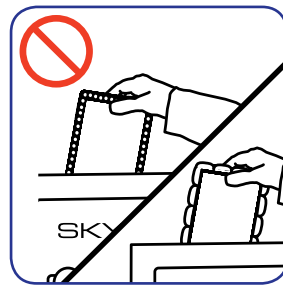

Do not process a device with jewels, decorations or excessive ridges on the case. Smooth surfaces disinfect best.

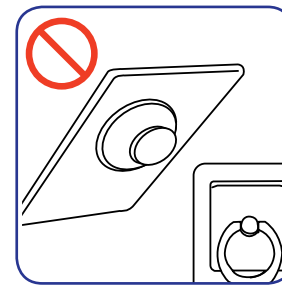

Do not process a device with a G-Hold® or an iRing® attached.

### Tips and Troubleshooting:

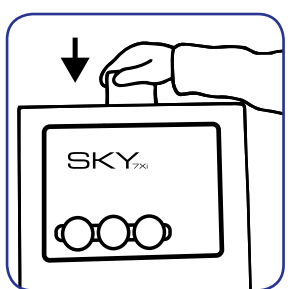

#### LOADING:

Insert the phone/tablet into slot and press downward firmly until the device begins to feed through the SKY.

When loading a phone or tablet into the SKY, it is important to center the device in the opening, screen facing back, and apply gentle pressure evenly on the device pressure until the SKY rollers grip and begin to feed the device into the unit.

Improperly loading devices into the drive rollers may cause the system to “time out” before the object is fully processed (and the object may not eject).

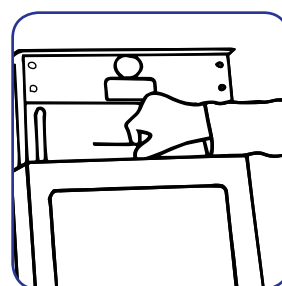
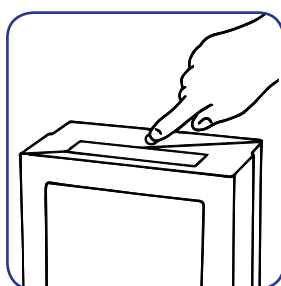
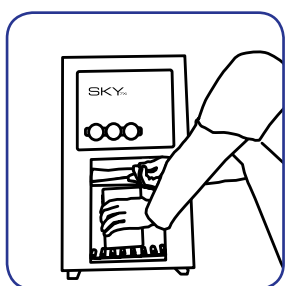

#### REMOVING STUCK ITEMS:

If phone or tablet does not eject from the system normally there are two methods for retrieving the object.

1) First, if the object is visible in the receiving area, lift the door fully and pull the device downward and out. Do not reach above the plastic “fingers” located on the inside of the door to retrieve an item.

2) Second, press the “open” latch button on the top of the SKY. To release the latch, you must first press downward on the face plate and then lift up on the knob. The object may be accessed from the door area or, if needed, the top of the cartridge can be lifted to release the phone or tablet from the cartridge. Once the phone or tablet has been retrieved, press the latch button back into the closed position and press down on the tray until seated. The system will resume operation.

## Questions: 1-800-558-2332

Always wear personal protective equipment.